

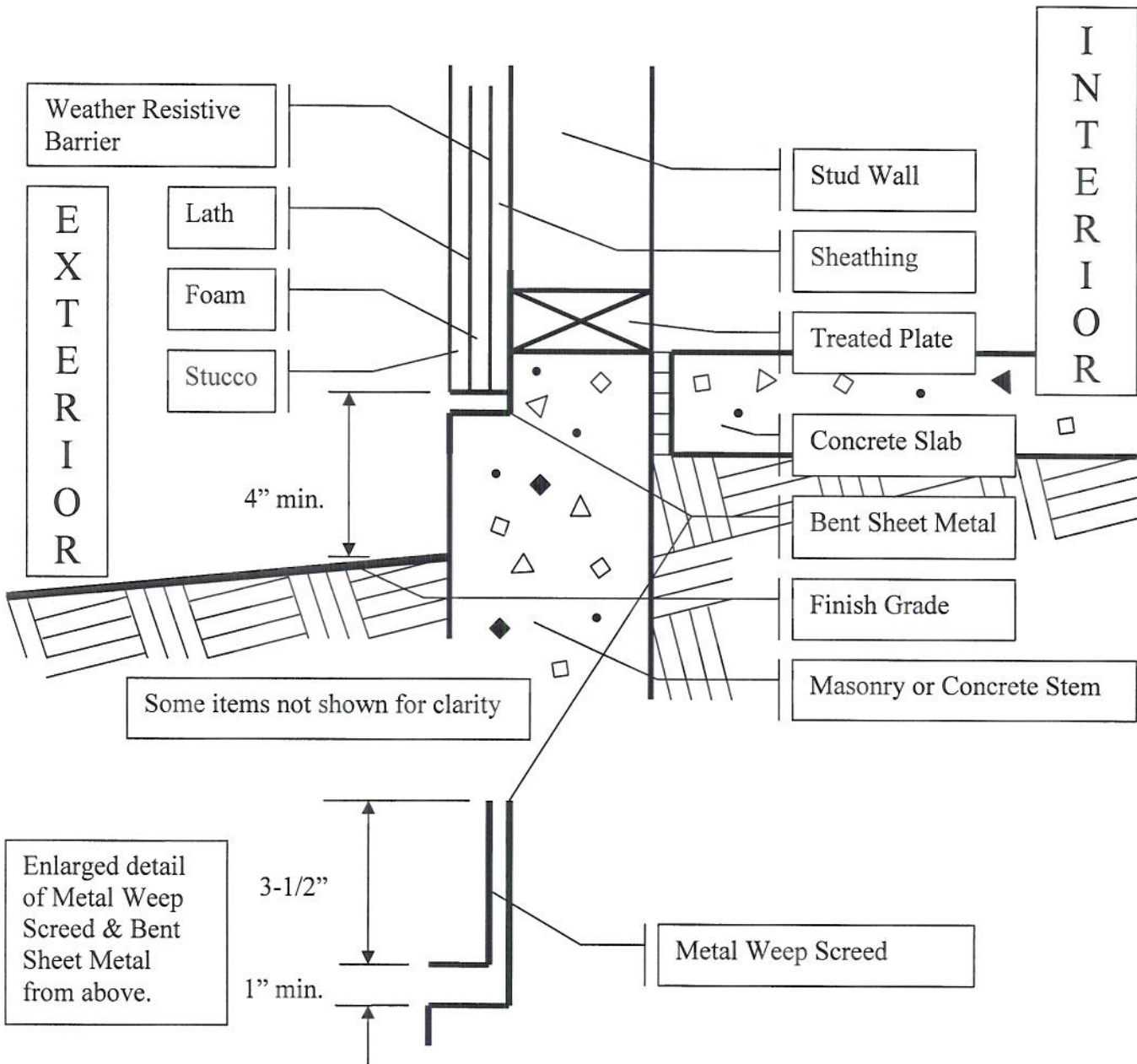

Approved Weep Scream Details



IRC R703.6.2.1 Weep screeds. A minimum 0.019-inch (No. 26 galvanized sheet gage), corrosion-resistant weep screed or plastic weep screed, with a minimum vertical attachment flange of 3½” shall be provided at or below the foundation plate line on exterior stud walls. The weep shall be placed a minimum of 4” above the earth or 2” above paved areas and shall be of a type that will allow trapped water to drain to the exterior of the building. The weather-resistive barrier shall lap the attachment flange. The exterior lath shall cover and terminate on the attachment flange of the weep screed.

IRC R703.6.2 Plaster. On wood-frame construction with an on-grade floor slab system, exterior plaster shall be applied in such a manner as to cover, but not extend below, lath, paper and screed.

